

31 Melbourne Avenue – Apartment # 305

Balcony



Living Room





Kitchen



Hallway



Bathroom



Bedroom 1 (front)



Bedroom 2 (back)



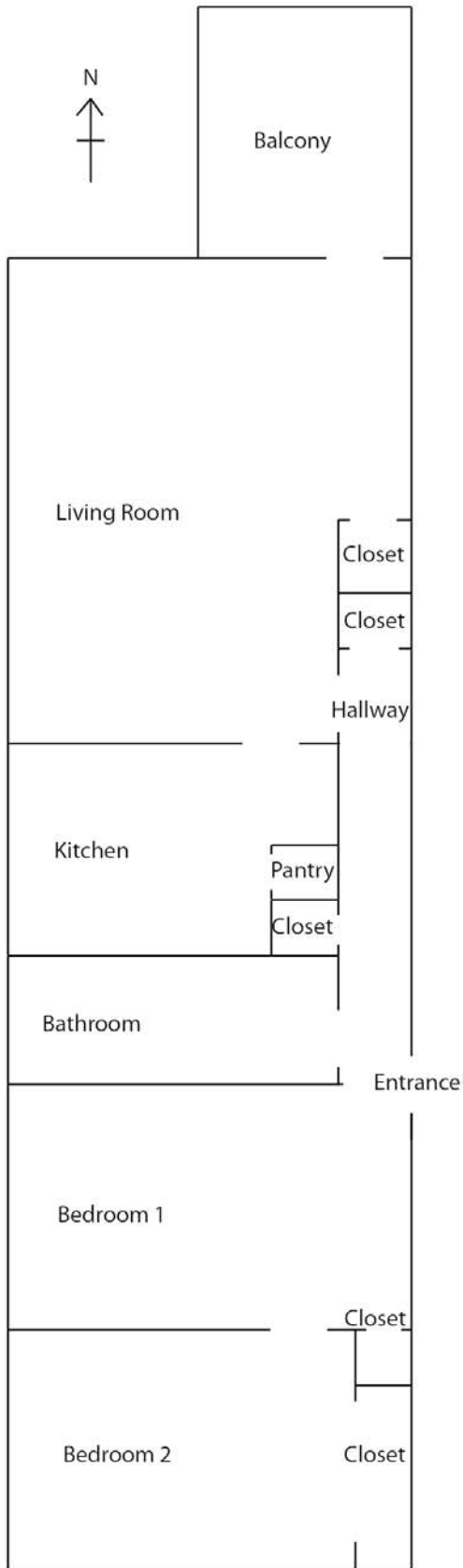

Approximate Square Footage
L (North to South) x W (West to East)

Balcony
 7'8" x 9'3" = 71'

Living Room
 17'5" x 14'6" = 252'6"

Closet 1 (Living Room)
 3'2" x 2'6" = 8'

Kitchen
 5'7" x 9' = 50'3"

Pantry (Kitchen)
 2' x 2'4" = 4'8"

Hallway
 17'6" x 2'6" = 43'9"

Closet 2 (Hallway - Front)
 2'7" x 2'6" = 6'6"

Closet (Hallway - Back)
 2'1" x 2'4" = 4'11"

Bathroom
 1'11" x 9'11" = 19'

Bedroom 1 (Front)
 8'9" x 12'6" = 109'

Closet 3 (Bedroom 1)
 1'11" x 1'9" = 3'4"

Bedroom 2 (Back)
 8'6" x 10' = 85'

Closet 4 (Bedroom 2)
 6'9" x 2'2" = 14'7"

Total Square Footage

Floor Space = 559'6"

Storage Space = 42'

Balcony = 71'